



关注WEIKEDUO
您将获得最新的行业资讯
Welcome to VKD
You will get our latest information

国家绿色工厂

Geological Mining Tools

CEMENTED CARBIDE



株洲威克多硬质合金有限公司

Zhuzhou Weikeduo Cemented Carbide Co., LTD.

ADDRESS: Building B, Smart Cube, No. 460, Jinshan Road, Hetang
Zhuzhou City, Hunan Province, China

Phone: +86 137 8633 2019 +86 186 7080 5093

Wechat&WhatsApp: +86 137 8633 2019 +86 177 0056 1536

Email: cathy@weikeduocarbide.com

admin@weikeduocarbide.com

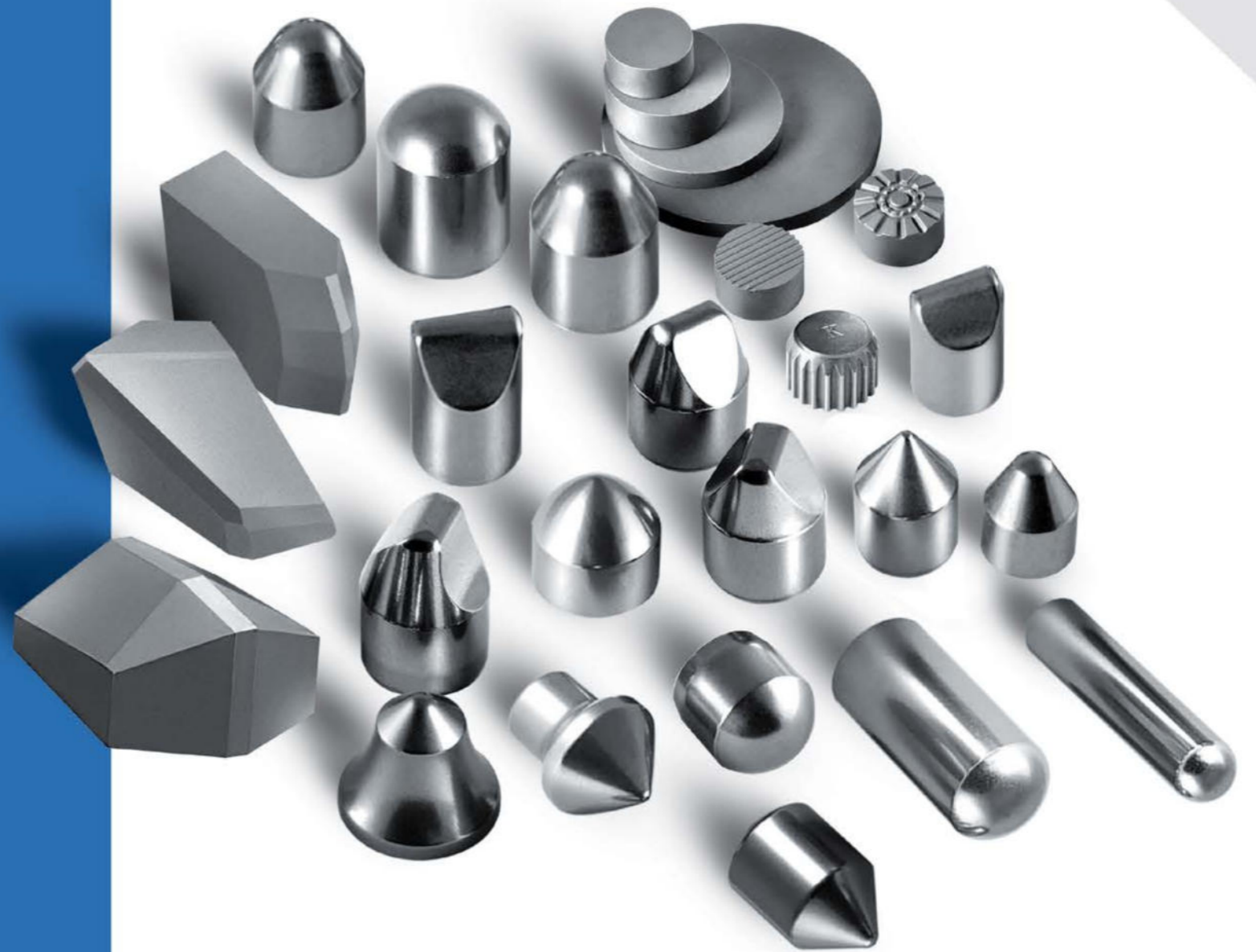

2024年版

www.vkdcarbide.com



Production Capacity

Weikeduo possesses high-precision mold production lines, automated and efficient inclinable ball mills and spray drying granulation system, fully automated TPA pressing and forming equipment, imported pressure sintering furnaces, as well as a constant temperature and humidity-controlled production environment. These highly specialized and automated production facilities fully ensure the stability of product quality and the efficiency of production.

We are dedicated to the R&D, production, and sales of cemented carbide for drilling and excavation. With a wide range of products and matured technology, it has now become a key strategic partner in fields such as oil fields, mining, engineering construction, and infrastructure development.



Research&Development Capacity

Weikeduo firmly believes in the power of technological innovation, and adheres to the talent philosophy of "leading with talent, co-creating and sharing". Over the years, we have independently built a high-level R&D talent team, earning the prestigious designation "Hunan Enterprise Technology Center" from the government. To date, we have secured over 20 patents.

In the journey of exploring advanced hard materials, we have been recognized for several national recognitions such as "National High-tech Enterprise", "National Torch Program", "National Little Giant Enterprise".



- ① 扫描电镜 Scanning Electron Microscope
- ② 图像尺寸测量仪 Image Size Measuring Instrument
- ③ 洛氏硬度计 Rockwell Hardness Tester
- ④ 金相显微镜 Metallographic Microscope
- ⑤ 钻磁、矫顽磁力测量仪 Cobalt Magnetic Instrument, Magnetic Measuring Instrument
- ⑥ 粒度分析仪 Laser Particle Size Distribution Instrument





Insert for Mining

矿山开采用合金

用于潜孔钻头、液压螺纹钻头和锥孔连接钻头，产品质量处于行业先进水平。特殊岩层可根据具体岩石情况提供定制化解决方案。

Suitable for DTH, threaded and taper bits, etc. The quality is at the advanced level of the industry. Customized solutions can be provided based on the specific characteristics of the rock formation.



| 牌号 Grade | 钴含量 Cobalt (%) ±0.3 | 密度 Density (g/cm3)±0.1 | 硬度 Hardness (HRA)±0.5 | 抗弯 强度 TRS(Mpa) | 牌号应用介绍 Recommended Application |
|-------------|---------------------------|------------------------------|-----------------------------|----------------------|--|
| VKD06V | 6 | 14.97 | 90.5 | 3100 | 高风压潜孔钻头或液压螺纹钻头；适用于坚硬岩层。 1. High air pressure DTH bits, threaded bits; 2. Suitable for hard rock formations. |
| VKD06L | 6 | 14.95 | 90.2 | 3000 | 高风压潜孔钻头或液压螺纹钻头；适用于中硬、硬岩层。 1. High air pressure DTH bits, threaded bits; 2. Suitable for medium and hard rock formations. |
| VKD06H | 6 | 14.95 | 90.0 | 2800 | 高风压潜孔钻头或液压螺纹钻头；适用于中软岩层。 1. High air pressure DTH bits, threaded bits; 2. Suitable for medium-soft rock formations. |
| VKD06 | 6 | 14.95 | 90.0 | 2600 | 低风压潜孔钻头或小直径锥孔连接钻头；适用于软岩层。 1. Low air pressure DTH bits, taper bits; 2. Suitable for soft rock formations. |
| VKD07V | 6.5 | 14.90 | 90.0 | 3000 | 大直径潜孔冲击钻头；适用于复杂岩层。 1. Large diameter DTH bits; 2. Suitable for complex rock formation. |
| VKD07L | 6.5 | 14.90 | 89.5 | 3000 | 多次修磨的液压螺纹钻头；尤其适用于硬岩或冲击功大的岩层。 1. Threaded bits that can be regrinding; 2. Especially suitable for hard or high impact power rock formation. |
| VKD30 | 8 | 14.75 | 88.5 | 2800 | 焊接类小直径钻头；适用于岩层复杂的中软岩层。 1. Welded DTH bits; 2. Suitable for complex medium-soft rock formation. |

Insert for Picks

硬岩铁挖用合金

用于桩基旋挖、巷道掘进、煤炭综采和路面工程，产品质量处于行业先进水平。特殊岩层可根据具体岩石情况提供定制化解决方案。

Suitable for rotary excavating, roadway excavation, coal mining and road milling, The quality is at the advanced level of the industry. Customized solutions can be provided based on the specific characteristics of the rock formation.

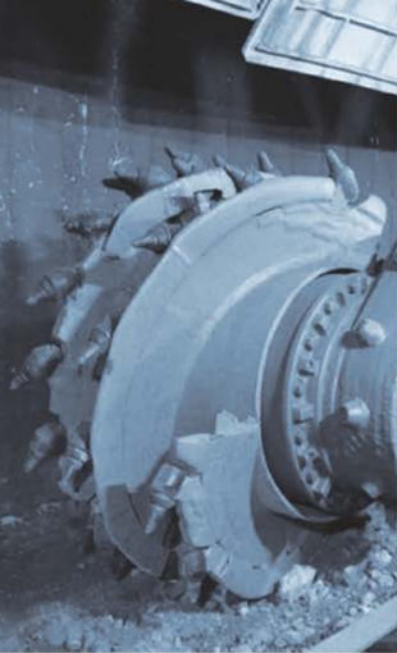

| 牌号 Grade | 钴含量 Cobalt (%)±0.3 | 密度 Density (g/cm3)±0.1 | 硬度 Hardness (HRA)±0.5 | 抗弯 强度 TRS(Mpa) | 晶粒度 Grain size (µm) | 牌号应用介绍 Recommended Application |
|-------------|--------------------------|------------------------------|-----------------------------|----------------------|---------------------------|--|
| VKJ06 | 6 | 14.95 | 88.0 | 2600 | 3-5 | 适用于沥青及混合路面铣削；具有良好的耐磨性、抗热疲劳及冲击韧性。 1. Suitable for milling of asphalt pavement and mixed road milling; 2. It has good wear resistance, thermal fatigue resistance and impact toughness. |
| VKJ25V | 6.5 | 14.90 | 86.0 | 2400 | 6-9 | 针对复杂工况较硬岩层下的煤炭综采和桩基旋挖；具有优越的冲击性能和抗热疲劳。 1. Suitable for coal mining and rotary excavating under complex working conditions; 2. Excellent impact performance and thermal fatigue resistance. |
| VKJ35L | 8 | 14.75 | 85.5 | 2400 | 6-8 | 针对复杂工况较硬岩层下的巷道掘进和桩基旋挖，使用寿命进一步提升。 1. Suitable for roadway excavation and rotary excavating under complex working conditions; 2. Service life is further improved. |
| VKJ35V | 8.5 | 14.70 | 85.5 | 2600 | 6-8 | 针对复杂工况较硬岩层下的煤炭综采和巷道掘进；具有优越的冲击性能和抗热疲劳。 1. Suitable for coal mining and roadway excavation under complex working conditions; 2. Excellent impact performance and thermal fatigue resistance. |
| VKJ38H | 9.5 | 14.55 | 85.5 | 2600 | 4-6 | 中硬岩层巷道掘进和含有煤研石的煤层综采；具有良好的冲击韧性。 1. Suitable coal mining and roadway excavation under medium rock formation; 2. It has good impact toughness. |

Super Hard Material Substrate

超硬材料复合片基体

用于油气、矿山、刀片类超硬材料的复合，产品质量处于行业先进水平。

Suitable for oil & gas and mining PDC cutter and PCD cutting tools, The quality is at the advanced level of the industry.

| 牌号 Grade | 钴含量 Cobalt (%) ±0.3 | 密度 Density (g/cm ³)±0.1 | 硬度 Hardness (HRA)±0.5 | 抗弯 强度 TRS(Mpa) | 牌号应用介绍 Recommended Application |
|-------------|---------------------------|---|-----------------------------|----------------------|--|
| YG10X | 10 | 14.55 | 90.0 | 3100 | 适用于超硬材料刀具复合片。 Suitable for PCD cutting tool. |
| VFD40 | 11 | 14.45 | 88.0 | 3100 | 适用于超硬材料刀具复合片。 Suitable for PCD cutting tool. |
| VY40X | 11 | 14.45 | 89.0 | 3300 | 适用于油气钻采用金刚石复合片。 Suitable for the PDC Cutters for oil & gas exploitation. |
| VFD45 | 13 | 14.25 | 88.0 | 3100 | 适用于超硬材料刀具复合片。 Suitable for PCD cutting tool. |
| VY45X | 13 | 14.25 | 88.5 | 3400 | 适用于油气钻采用金刚石复合片。 Suitable for the PDC Cutters for oil & gas exploitation. |
| VK60 | 16 | 13.95 | 85.5 | 2800 | 适用于地质、矿山用金刚石复合片。 Suitable for PDC cutter for geological exploration, mine drilling. |
| VY60X | 16 | 13.95 | 86.5 | 3000 | 适用于地质、矿山用金刚石复合片。 Suitable for PDC cutter for geological exploration, mine drilling. |

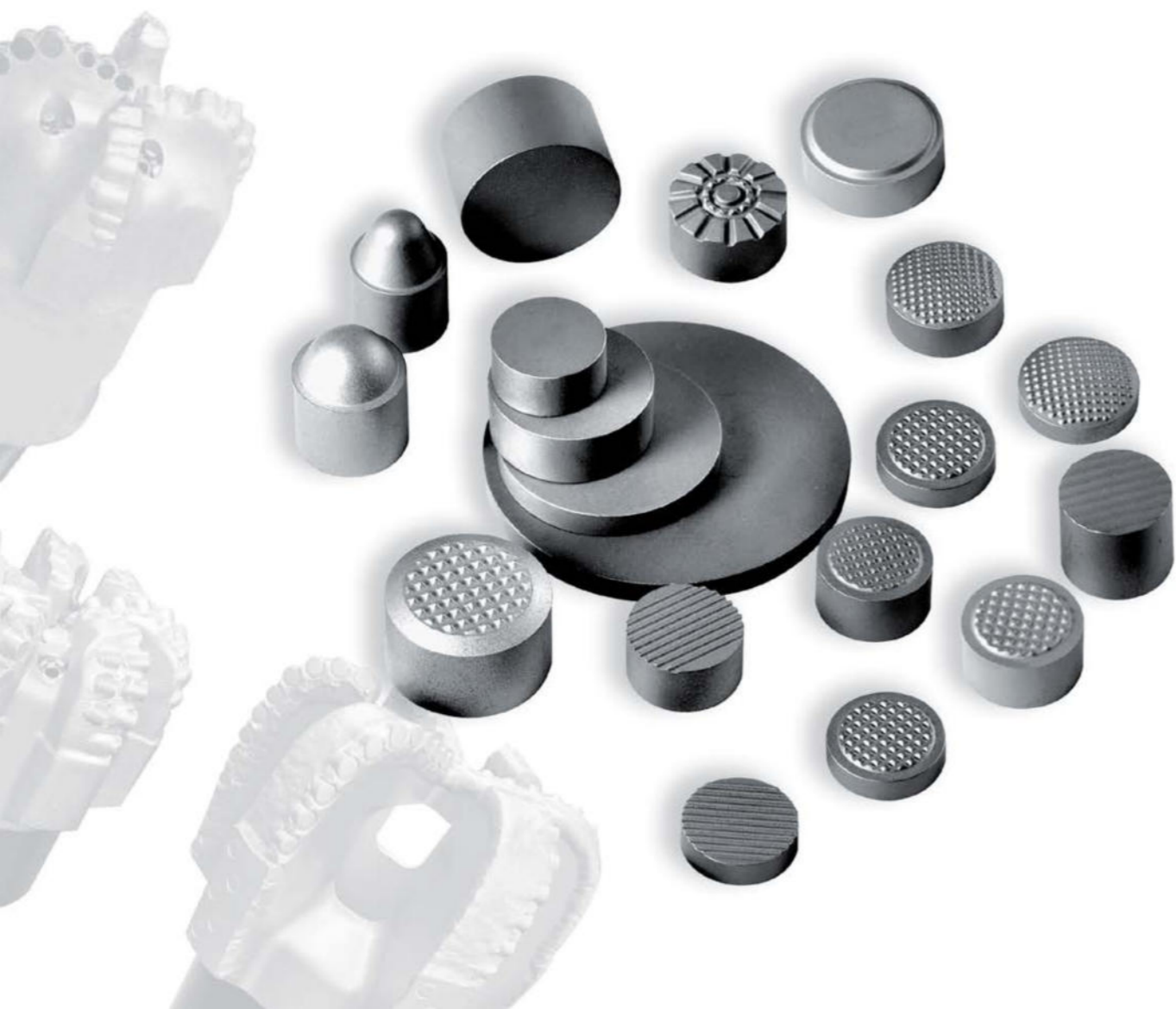

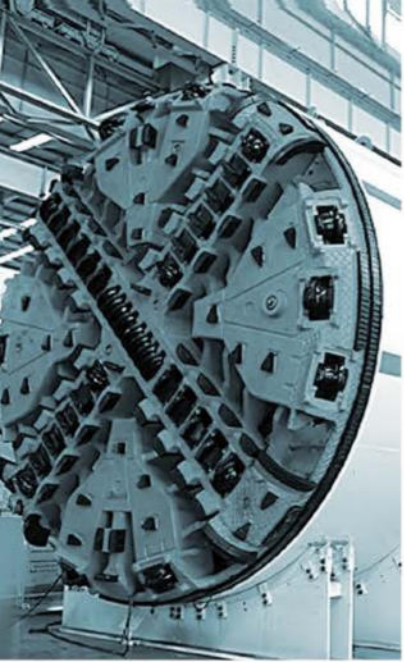

Insert for Construction

工程应用类合金

用于矿用牙轮钻、滚刀、盘刀、高压辊磨机
和工程铲挖，产品质量处于行业先进水平。特殊
岩层可根据具体岩石情况提供定制化解决方案。

Suitable for mining tricone bits, roller cutters, disc
cutters, HPGR and excavation, The quality is at the
advanced level of the industry. Customized solutions
can be provided based on the specific characteristics
of the rock formation.



| 牌号 Grade | 钴含量 Cobalt (%) ±0.3 | 密度 Density (g/cm3)±0.1 | 硬度 Hardness (HRA)±0.5 | 抗弯 强度 TRS(Mpa) | 牌号应用介绍 Recommended Application |
|-------------|---------------------------|------------------------------|-----------------------------|----------------------|--|
| VK30 | 8 | 14.75 | 88.5 | 2800 | 适用于保径齿、背锥齿、锯形齿、镶制地质勘探用岩心钻头、油井钻头、刮刀钻头及TC轴承、凿岩稳定器等耐磨件。 1. Applicable for gauge protection inserts, and serrated inserts, as well as wear-resistant components used in geological exploration core bits, oil well bits, drag bits, TC bearings, and rock drilling stabilizers. |
| VK38Y | 10 | 14.50 | 88.0 | 3000 | 矿用牙轮钻头合金，适用于中硬岩层或有色金属矿山的钻探。 1. Mining tricone bits; 2. Suitable for drilling in medium-hard rock formations or non-ferrous metal mines. |
| VK38 | 10 | 14.50 | 87.5 | 2900 | 矿用牙轮钻头合金和滚刀钻头合金，适用于中硬岩层。 1. Mining tricone bits and roller cutters; 2. Suitable for medium-hard rock formations. |
| VK40Y | 11 | 14.40 | 87.5 | 3000 | 矿用牙轮钻头合金，适用于中硬或硬的岩层。 1. Mining tricone bits; 2. Suitable for medium-hard or hard rock formations. |
| VK40 | 11 | 14.40 | 87.0 | 2900 | 矿用牙轮钻头合金、滚刀钻头合金，适用于偏软或中硬的岩层。 1. Mining tricone bits and roller cutters; 2. Suitable for softer or medium-hard rock formations. |
| VK45 | 13 | 14.25 | 86.5 | 2900 | 滚刀钻头合金，适用于耐腐蚀性中等、抗压强度中等的岩层。 1. Roller cutters; 2. Suitable for rock formations with medium corrosion resistance and compressive strength. |
| VK50 | 15 | 14.00 | 85.5 | 2900 | 适用于各种工况的耐磨件及各类盾构刀具用合金。 1. Suitable for wear-resistant components in various working conditions and used in different types of shield tunneling cutter tools. |
| VY60 | 16 | 13.95 | 86.5 | 3100 | 滚刀钻头合金，适用于中硬或硬岩层。 1. Roller cutters; 2. Suitable for medium-hard or hard rock formations. |
| YG16C | 16 | 13.95 | 84.5 | 2600 | 滚刀钻头合金，适用于抗压强度大的硬或极硬岩层。 1. Roller cutters; 2. Suitable for hard or extremely hard rock formations with high compressive strength. |



Insert for Oil & Gas Tricone Bit

油田牙轮钻齿

用于油用牙轮钻，复合钻头，产品质量处于行业先进水平。特殊岩层可根据具体岩石情况提供定制化解决方案。

Suitable for oil & gas tricone bits. The quality is at the advanced level of the industry. Customized solutions can be provided based on the specific characteristics of the rock formation.



| 牌号 Grade | 钴含量 Cobalt (%)±0.3 | 密度 Density (g/cm3)±0.1 | 硬度 Hardness (HRA)±0.5 | 抗弯 强度 TRS(Mpa) | 牌号应用介绍 Recommended Application |
|-------------|--------------------------|------------------------------|-----------------------------|----------------------|---|
| VY38 | 10 | 14.50 | 88.5 | 3100 | 油用牙轮钻头合金，适用于硬或极硬岩层。 1. Oilfield tricone bits; 2. Suitable for hard or extremely hard rock formations. |
| VK38 | 10 | 14.50 | 87.5 | 2900 | 油用牙轮钻头合金，适用于硬岩层。 1. Oilfield tricone bits; 2. Suitable for hard rock formations. |
| VK40 | 11 | 14.40 | 87.0 | 2900 | 油用牙轮钻头合金，适用于偏软或中硬岩层。 1. Oilfield tricone bits; 2. Suitable for softer or medium-hard rock formations. |
| VY40 | 11 | 14.40 | 87.5 | 2900 | 油用牙轮钻头合金，适用于中硬或硬岩层。 1. Oilfield tricone bits; 2. Suitable for medium-hard or hard rock formations. |
| VY45 | 13 | 14.25 | 87.5 | 3100 | 油用牙轮钻头合金，适用于中硬或硬岩层。 1. Oilfield tricone bits; 2. Suitable for medium-hard or hard rock formations. |
| VK50 | 15 | 14.00 | 85.5 | 2900 | 油用牙轮钻头合金，适用于中硬或硬岩层。 1. Oilfield tricone bits; 2. Suitable for medium-hard or hard rock formations. |
| VY60 | 16 | 13.95 | 86.5 | 3100 | 油用牙轮钻头合金，适用于坚硬或较复杂岩层。 1. Oilfield tricone bits; 2. Suitable for hard or more complex rock formations. |

球形齿 Spherical Inserts



单位Dimension: mm

| 型号Type | D | H | h | R |
|----------|-------|------|-------|-------|
| SQ072100 | 7.20 | 10.0 | 2.80 | 3.70 |
| SQ080870 | 8.20 | 8.7 | 2.60 | 4.35 |
| SQ082120 | 8.20 | 12.0 | 3.50 | 4.06 |
| SQ096117 | 9.60 | 11.7 | 3.91 | 4.90 |
| SQ092130 | 9.20 | 13.0 | 3.70 | 4.60 |
| SQ100150 | 10.20 | 15.0 | 4.07 | 5.15 |
| SQ112165 | 11.20 | 16.5 | 5.10 | 5.51 |
| SQ122180 | 12.20 | 18.0 | 5.20 | 6.04 |
| SQ132190 | 13.18 | 19.0 | 5.34 | 6.65 |
| SQ142210 | 14.18 | 21.0 | 5.70 | 7.20 |
| SQ162230 | 16.18 | 23.0 | 6.30 | 8.20 |
| SQ192270 | 19.18 | 27.0 | 8.00 | 7.94 |
| SQ202280 | 20.18 | 28.0 | 8.64 | 10.12 |
| SQ222300 | 22.20 | 30.0 | 9.20 | 11.21 |
| SQ243350 | 24.30 | 35.0 | 10.39 | 12.23 |
| SQ255350 | 25.50 | 35.0 | 10.35 | 12.88 |

注：尺寸、齿形可根据客户要求定制
Note: The dimensions and shape can be customized according to the customer's requirements.

锥形齿 Conical Inserts



单位Dimension: mm

| 型号Type | D | H | h | R | a |
|----------|-------|------|-------|------|------|
| SZ072110 | 7.20 | 11.0 | 3.24 | 3.00 | 30.0 |
| SZ082115 | 8.15 | 11.5 | 4.21 | 3.00 | 28.8 |
| SZ093145 | 9.31 | 14.5 | 5.65 | 3.50 | 21.0 |
| SZ103165 | 10.30 | 16.5 | 5.54 | 2.50 | 30.8 |
| SZ112160 | 11.20 | 16.0 | 6.10 | 4.00 | 27.5 |
| SZ122190 | 12.20 | 19.0 | 9.76 | 2.38 | 25.0 |
| SZ132180 | 13.20 | 18.0 | 7.14 | 4.50 | 28.0 |
| SZ142210 | 14.18 | 21.0 | 7.70 | 5.00 | 27.5 |
| SZ152220 | 15.20 | 21.0 | 9.30 | 5.00 | 25.0 |
| SZ162250 | 16.18 | 25.0 | 8.81 | 6.00 | 26.0 |
| SZ182280 | 18.20 | 28.0 | 10.14 | 6.00 | 27.5 |
| SZ193280 | 19.37 | 28.0 | 13.00 | 6.20 | 22.5 |
| SZ223296 | 22.30 | 29.6 | 12.60 | 9.50 | 18.5 |

注：尺寸、齿形可根据客户要求定制
Note: The dimensions and shape can be customized according to the customer's requirements.

抛物线齿 Parabolic Inserts



单位Dimension: mm

| 型号Type | D | H | h | R1 | R2 |
|----------|-------|------|-------|------|-------|
| SD072110 | 7.20 | 11.0 | 3.93 | 1.91 | 8.65 |
| SD082120 | 8.20 | 12.0 | 4.30 | 2.25 | 8.00 |
| SD092130 | 9.20 | 13.0 | 5.00 | 3.20 | 8.70 |
| SD103139 | 10.30 | 13.9 | 5.55 | 3.60 | 9.50 |
| SD112160 | 11.20 | 16.0 | 5.75 | 2.75 | 11.00 |
| SD122181 | 12.20 | 18.1 | 6.02 | 3.00 | 12.00 |
| SD132190 | 13.18 | 19.0 | 5.57 | 3.25 | 13.00 |
| SD142220 | 14.25 | 22.0 | 9.00 | 4.00 | 14.00 |
| SD162230 | 16.18 | 23.0 | 8.64 | 5.92 | 16.00 |
| SD182270 | 18.20 | 27.0 | 11.49 | 4.00 | 43.00 |
| SD202290 | 20.20 | 29.0 | 11.00 | 5.00 | 18.00 |

注：尺寸、齿形可根据客户要求定制
Note: The dimensions and shape can be customized according to the customer's requirements.

锯形齿 Serrated Inserts

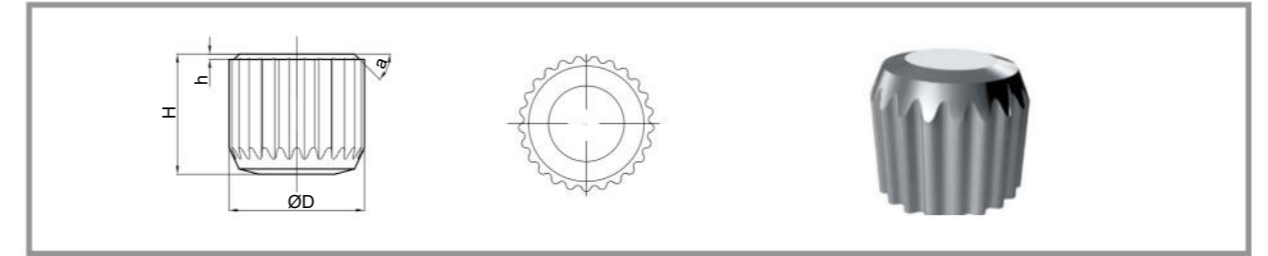

单位Dimension: mm

| 型号Type | D | H | h | a |
|----------|-------|------|------|-----|
| SP065048 | 6.50 | 4.80 | 1.10 | 15° |
| SP082065 | 8.20 | 6.50 | 1.90 | 25° |
| SP098080 | 9.80 | 8.00 | 1.90 | 25° |
| SP113088 | 11.27 | 8.40 | 2.54 | 15° |
| SP128088 | 12.83 | 8.84 | 2.54 | 15° |
| SP149095 | 14.94 | 9.52 | 3.60 | 18° |

注：尺寸、齿形可根据客户要求定制
Note: The dimensions and shape can be customized according to the customer's requirements.

平顶齿 Flat Inserts



单位Dimension: mm

| 型号Type | D | H | h | a |
|----------|-------|-------|------|-----|
| SP041046 | 4.10 | 4.60 | 0.80 | 45° |
| SP050047 | 5.00 | 4.70 | 1.17 | 45° |
| SP064059 | 6.42 | 5.94 | 1.17 | 45° |
| SP080080 | 8.00 | 8.00 | 1.17 | 45° |
| SP096083 | 9.60 | 8.33 | 1.17 | 45° |
| SP114100 | 11.44 | 10.00 | 1.27 | 45° |
| SP122100 | 12.22 | 10.00 | 1.00 | 45° |
| SP143120 | 14.50 | 12.00 | 1.20 | 45° |
| SP160150 | 16.00 | 15.00 | 1.50 | 18° |
| SP204150 | 20.37 | 15.00 | 2.50 | 45° |

注：尺寸、齿形可根据客户要求定制
Note: The dimensions and shape can be customized according to the customer's requirements.

楔形齿 Chisel Inserts



单位Dimension: mm

| 型号Type | D | H | h | R |
|----------|--------|-------|-------|------|
| SX050067 | 5.000 | 6.73 | 2.13 | 0.89 |
| SX072101 | 7.215 | 10.07 | 4.50 | 2.00 |
| SX080116 | 8.009 | 11.56 | 5.08 | 1.57 |
| SX096132 | 9.596 | 13.23 | 4.42 | 0.89 |
| SX112157 | 11.184 | 15.27 | 5.52 | 0.89 |
| SX128174 | 12.771 | 17.41 | 7.09 | 2.39 |
| SX131171 | 13.100 | 17.08 | 6.75 | 2.75 |
| SX143190 | 14.359 | 19.00 | 9.00 | 2.75 |
| SX159215 | 15.946 | 21.49 | 7.59 | 0.89 |
| SX175273 | 17.544 | 27.34 | 11.13 | 3.96 |
| SX191333 | 19.134 | 33.32 | 13.71 | 5.16 |
| SX223233 | 22.309 | 23.27 | 10.42 | 4.91 |
| SX255299 | 25.484 | 29.87 | 12.20 | 5.00 |
| SX301470 | 30.084 | 47.00 | 19.00 | 6.00 |
| SX321520 | 32.084 | 52.00 | 22.00 | 6.00 |

注：尺寸、齿形可根据客户要求定制
 Note: The dimensions and shape can be customized according to the customer's requirements.

勺形齿 Spoon Inserts

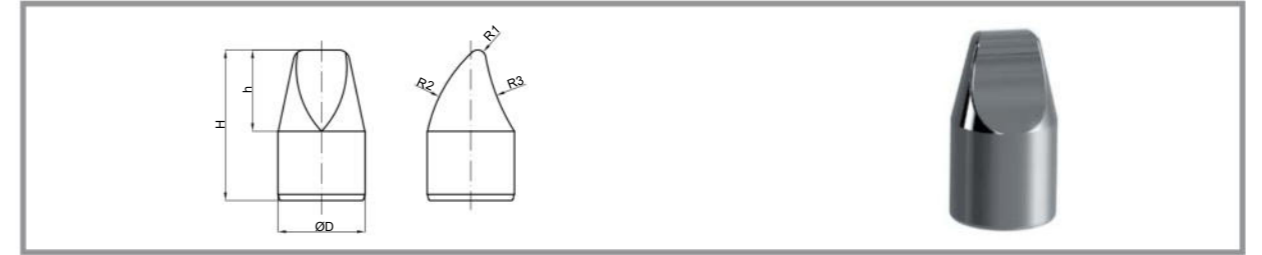

单位Dimension: mm

| 型号Type | D | H | h | R1 | R2 | R3 |
|----------|--------|-------|-------|------|-------|-------|
| SS080122 | 8.009 | 12.18 | 5.50 | 1.27 | 8.10 | 19.50 |
| SS096133 | 9.596 | 13.28 | 5.13 | 2.77 | 4.01 | 11.23 |
| SS104125 | 10.400 | 12.50 | 5.50 | 2.00 | 18.00 | 18.00 |
| SS112149 | 11.184 | 14.92 | 6.75 | 1.98 | 7.32 | 23.31 |
| SS143206 | 14.359 | 20.65 | 9.22 | 2.39 | 10.85 | 16.64 |
| SS159239 | 15.946 | 23.87 | 9.93 | 3.58 | 16.15 | 18.90 |
| SS175282 | 17.544 | 28.18 | 11.93 | 2.39 | 15.28 | 22.46 |
| SS191294 | 19.134 | 29.45 | 11.93 | 2.39 | 14.06 | 20.18 |
| SS223333 | 22.309 | 33.34 | 14.30 | 2.77 | 19.12 | 22.77 |
| SS255434 | 25.484 | 43.37 | 18.00 | 3.00 | 29.45 | 30.31 |
| SS281455 | 28.084 | 45.50 | 21.00 | 2.5 | 36.14 | 36.62 |
| SS301475 | 30.084 | 47.50 | 23.00 | 2.75 | 44.59 | 44.75 |

注：尺寸、齿形可根据客户要求定制
 Note: The dimensions and shape can be customized according to the customer's requirements.

边楔齿 Side Wedged Inserts

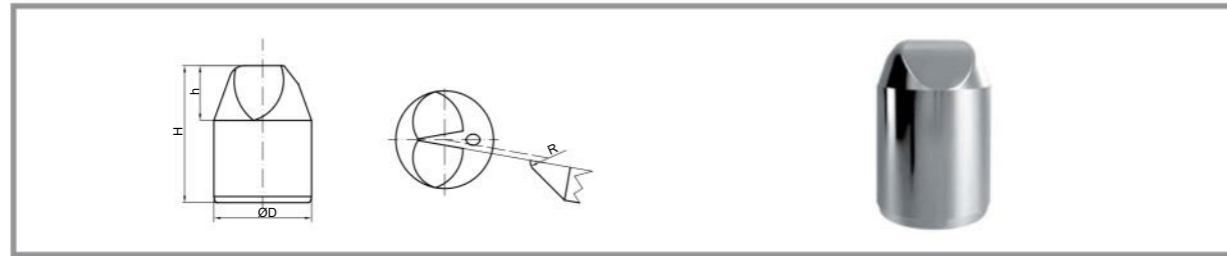

单位Dimension: mm

| 型号Type | D | H | h | R |
|----------|--------|-------|-------|------|
| BX077101 | 7.660 | 10.05 | 2.13 | 2.68 |
| BX084108 | 8.370 | 10.80 | 4.00 | 2.00 |
| BX096119 | 9.596 | 11.89 | 4.40 | 3.96 |
| BX104140 | 10.400 | 14.00 | 2.00 | 2.36 |
| BX112150 | 11.184 | 14.99 | 5.11 | 2.39 |
| BX127174 | 12.771 | 17.42 | 5.74 | 3.58 |
| BX134175 | 13.370 | 17.50 | 6.50 | 4.50 |
| BX143191 | 14.359 | 19.07 | 5.77 | 3.96 |
| BX159215 | 15.946 | 21.49 | 7.19 | 4.78 |
| BX191270 | 19.134 | 27.05 | 10.08 | 3.18 |
| BX255389 | 25.484 | 38.88 | 15.28 | 3.18 |
| BX281380 | 28.084 | 38.00 | 15.00 | 3.18 |
| BX321450 | 32.084 | 45.00 | 18.00 | 3.18 |

注：尺寸、齿形可根据客户要求定制
 Note: The dimensions and shape can be customized according to the customer's requirements.

高压辊磨机用柱钉 Studs for HPGR

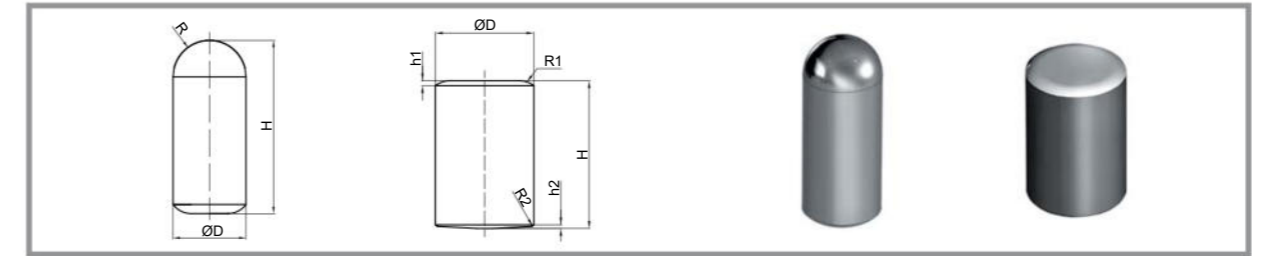

单位Dimension: mm

| 齿形 Shape | D | H | R |
|-----------------|----|-------------------|----|
| 球头 Spherical | 10 | 25/30/35/40/50/60 | 5 |
| | 16 | 25/30/35/40/50/60 | 8 |
| | 20 | 25/30/35/40/50/60 | 10 |
| 平头 Flat | 10 | 25/30/35/40/50/60 | |
| | 16 | 25/30/35/40/50/60 | |
| | 20 | 25/30/35/40/50/60 | |

注：尺寸、齿形可根据客户要求定制
 Note: The dimensions and shape can be customized according to the customer's requirements.

合金块 Blocks

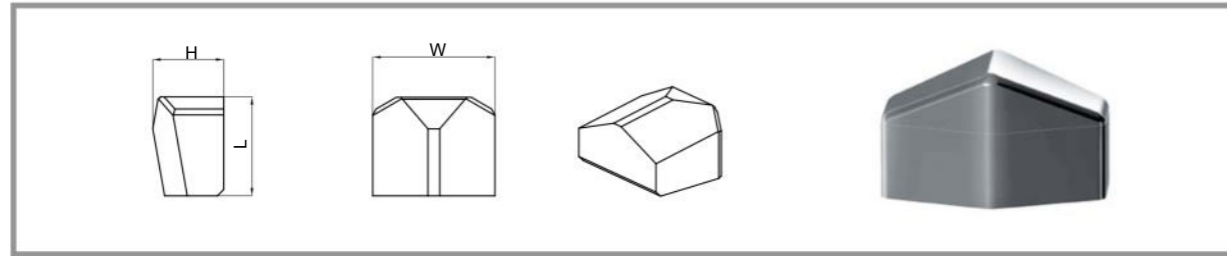

单位Dimension: mm

| L | W | H |
|------|------|-----|
| 16 | 25.5 | 38 |
| 22.4 | 8.5 | 7.5 |
| 25 | 8.5 | 7.7 |
| 31 | 25 | 18 |
| 35 | 50 | 25 |
| 38 | 30 | 20 |
| 38 | 24 | 18 |
| 39 | 25 | 18 |
| 46 | 28 | 28 |

注：尺寸、齿形可根据客户要求定制
Note: The dimensions and shape can be customized according to the customer's requirements.

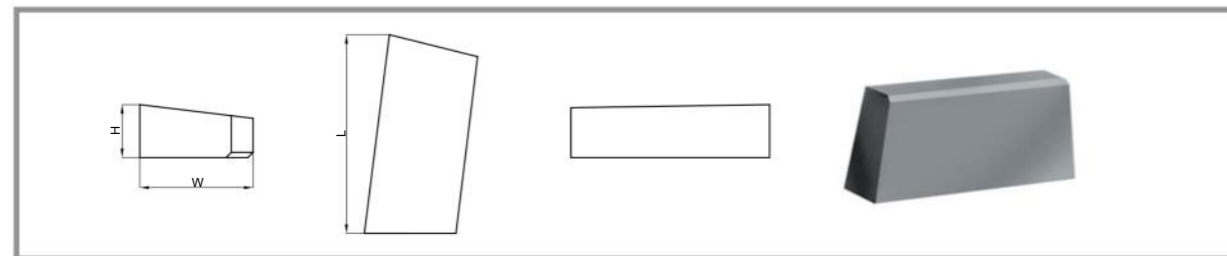

单位Dimension: mm

| L | W | H |
|-----|----|----|
| 115 | 52 | 30 |

注：尺寸、齿形可根据客户要求定制
Note: The dimensions and shape can be customized according to the customer's requirements.

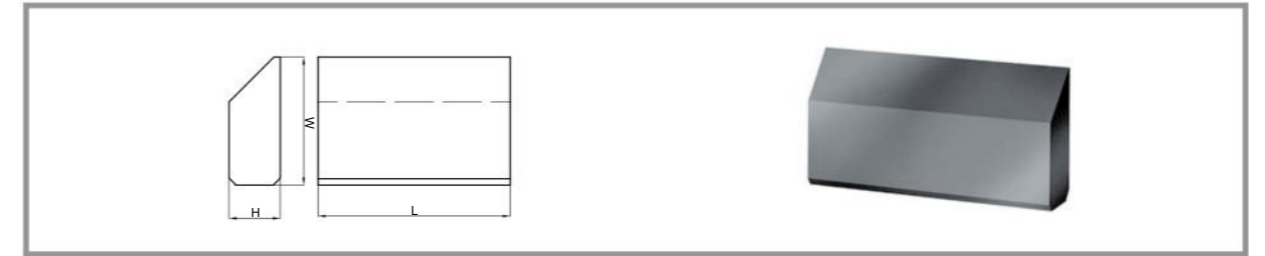

单位Dimension: mm

| L | W | H |
|----|----|---|
| 28 | 15 | 6 |

注：尺寸、齿形可根据客户要求定制
Note: The dimensions and shape can be customized according to the customer's requirements.

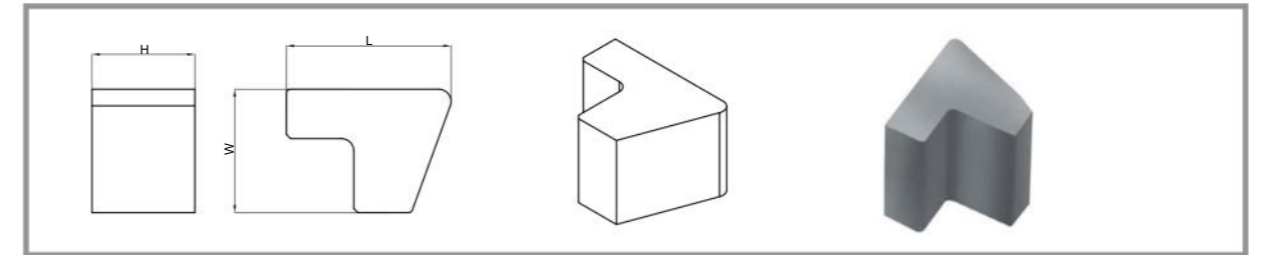

单位Dimension: mm

| L | W | H |
|----|----|----|
| 45 | 40 | 50 |

注：尺寸、齿形可根据客户要求定制
Note: The dimensions and shape can be customized according to the customer's requirements.

路面铣刨齿 Pavement Milling Inserts



单位Dimension: mm

| 型号Type | D | d | H | h |
|-----------|------|------|------|------|
| WL159160 | 15.9 | 7.8 | 16 | 1.5 |
| WL175167D | 17.5 | 9.6 | 16.7 | 1 |
| WL185195 | 18.5 | 10.6 | 19.5 | 1.7 |
| WL190182 | 19 | 11.5 | 18.2 | 1.5 |
| WL204202 | 20.4 | 11 | 20.2 | 1.95 |
| WL208198 | 20.8 | 11.7 | 19.8 | 2.5 |
| WL240187 | 24 | 17.2 | 18.7 | 1.9 |
| WL290260 | 29 | 19 | 26 | 3.5 |

注：尺寸、齿形可根据客户要求定制
Note: The dimensions and shape can be customized according to the customer's requirements.

直柱型截齿 Columnar Inserts



单位Dimension: mm

| 型号Type | D | H | R1 | R2 |
|---------------|------|----|----|------|
| MJ220280BD10Q | 22 | 28 | 2 | 26 |
| MJ250350D40 | 25 | 35 | 3 | 26 |
| MJ300370CD50 | 30 | 37 | 3 | 37.5 |
| MJ354400D20 | 35.4 | 40 | 4 | 50 |

注：尺寸、齿形可根据客户要求定制
Note: The dimensions and shape can be customized according to the customer's requirements.

倒锥型截齿 Columnar Inserts



单位Dimension: mm

| 型号Type | D | H | R1 | R2 |
|-----------------|------|------|-----|----------|
| MC235260CD05 | 23.5 | 26 | 2.5 | 33 |
| MC255300D05 | 25.5 | 30 | 2 | 30 |
| MC255335CD12Q20 | 25.5 | 33.5 | 2.5 | 84° /57° |
| MJ320400AD10Q | 32 | 40 | 4 | 42 |

注：尺寸、齿形可根据客户要求定制
Note: The dimensions and shape can be customized according to the customer's requirements.

蘑菇型截齿 Mushroom-shaped Inserts



单位Dimension: mm

| 型号Type | D | d | H | R1 | R2 |
|----------|----|------|----|-----|----|
| MC220340 | 22 | 15.5 | 34 | 2.5 | 35 |
| MC250320 | 25 | 20 | 32 | 2.5 | 40 |
| MJ300350 | 30 | 24.6 | 35 | 2.5 | 50 |
| MC330350 | 33 | 24.6 | 35 | 4.5 | 30 |
| MC340400 | 34 | 24.6 | 40 | 2.5 | 50 |

注：尺寸、齿形可根据客户要求定制
Note: The dimensions and shape can be customized according to the customer's requirements.

金刚石复合片基体 Super Hard Material Substrate

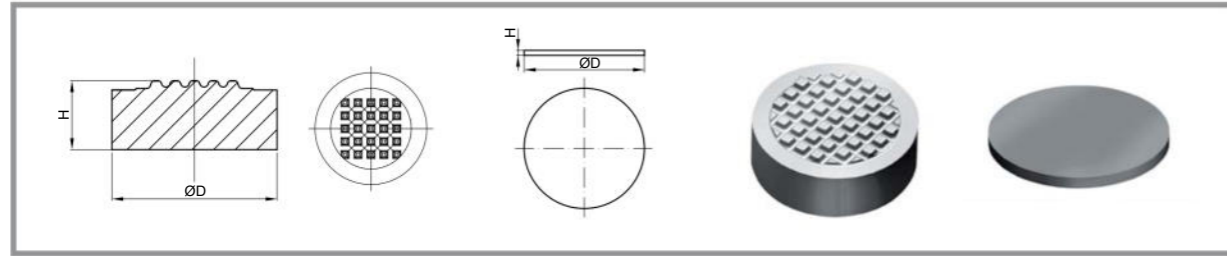

单位Dimension:(mm)

| | 型号Type | D | H |
|------------------------------|----------|------|------|
| 网格型 Grid pattern | JP147119 | 14.7 | 11.9 |
| | JP180120 | 18.0 | 12.0 |
| | JP209125 | 20.3 | 12.5 |
| 直线型 Straight-line pattern | JP112036 | 11.2 | 3.6 |
| | JP144040 | 14.4 | 4.0 |
| | JP146071 | 14.6 | 7.1 |
| 平面 Planar | JP520027 | 52 | 2.7 |
| | JP580027 | 58 | 2.7 |
| | JP620036 | 62 | 3.6 |
| | JP720046 | 72 | 4.6 |

注：尺寸、齿形可根据客户要求定制

Note: The dimensions and shape can be customized according to the customer's requirements.

| 洛氏硬度(3R) | | | | 维氏硬度 HV 荷重 30kg |
|----------------------|-------------------------|-----------------------|-----------------------|--------------------------|
| HRA 荷重60kg 金刚石 | HRB 荷重100kg 1/6"球 | HRC 荷重150kg 金刚石 | HRD 荷重100kg 金刚石 | |
| 92.5 | - | 80.5 | - | 1700 |
| 92.0 | - | 80.0 | - | 1600 |
| 91.5 | - | 79.0 | - | 1550 |
| 91.0 | - | 78.0 | - | 1500 |
| 90.5 | - | 77.0 | - | 1450 |
| 90.0 | - | 76.0 | - | 1400 |
| 89.5 | - | 75.0 | - | 1350 |
| 89.0 | - | 74.0 | - | 1300 |
| 88.5 | - | 73.0 | - | 1250 |
| 88.0 | - | 72.0 | - | 1200 |
| 87.5 | - | 71.5 | - | 1150 |
| 87.0 | - | 71.0 | - | 1140 |
| 86.5 | - | 70.0 | - | 1076 |
| 86.0 | - | 69.0 | - | 1004 |
| 85.6 | - | 68.0 | 76.9 | 940 |
| 85.3 | - | 67.5 | 76.5 | 920 |
| 85.0 | - | 67.0 | 76.1 | 900 |
| 84.7 | - | 66.4 | 75.7 | 880 |
| 84.4 | - | 65.9 | 75.3 | 860 |
| 84.1 | - | 65.3 | 74.8 | 840 |
| 83.8 | - | 64.7 | 74.3 | 820 |
| 83.4 | - | 64.0 | 73.8 | 800 |
| 83.0 | - | 63.3 | 73.3 | 780 |
| 82.6 | - | 62.5 | 72.6 | 760 |
| 82.2 | - | 61.8 | 72.1 | 740 |
| 81.8 | - | 61.0 | 715 | 720 |
| 81.3 | - | 60.1 | 70.8 | 700 |
| 81.1 | - | 59.7 | 70.5 | 690 |
| 80.8 | - | 59.2 | 70.1 | 680 |
| 80.6 | - | 58.8 | 69.8 | 670 |
| 80.3 | -- | 58.3 | 69.4 | 660 |
| 80.0 | - | 57.8 | 69.0 | 650 |
| 79.8 | - | 57.3 | 68.7 | 640 |
| 79.5 | - | 56.8 | 68.3 | 630 |